



HORIZON range solution

INSTALLATION OF MODULE USING HEX HEAD SELF-DRILLING SCREWS

- Ideally suited to horizontal façade layouts as well as for soffits
- Especially well suited to brick style joint layouts
- Easy installation after modifying basic profile
- Provides **very deep vertical recessed joints**, allows **vertical metal profiles** or other fixing elements to pass through (solar shading, perforated screening ..)
- Offers option of selecting the **width of the vertical joints**
- Offers option of increasing the width of the horizontal joints
- **Minimizes thickness of the overall system**
- Ensures a uniform and aesthetic appearance for large horizontal recessed joints

The PAROS® solution complies with the requirements of the CSTB (code of practice for building works) depending on the material used and the type of substrate.

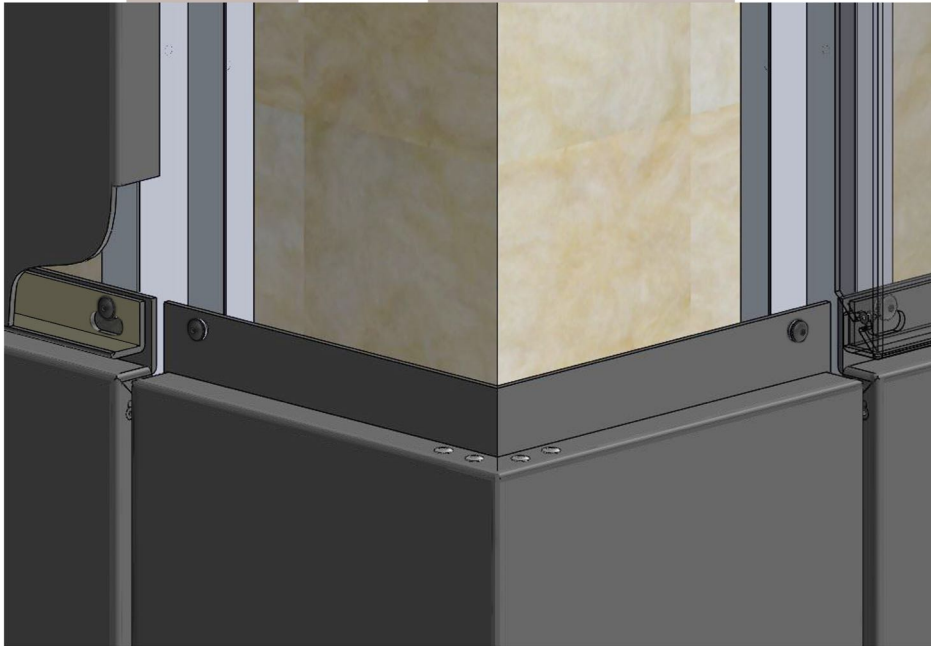

HORIZON range solution

- 1 Substrate
- 2 Insulation
- 3 Right angle fixing bracket
- 4 Secondary substructure
- 5 Hex head self-drilling screw
- 6 Metal or composite cladding

