

## HORIZON range solution

### INSTALLATION OF SLATS WITH INSERTS

- Suited to façade layouts with **horizontal slats**
- Suited to **brick style layouts**
- Recommended for a shingle look or a **dry joint** appearance
- Suited to installation on site **without prior assessment**
- **Available in a kit** with standard or customised length slats
- Adjustment of slat length possible on site
- Easy installation after modifying the basic profile
- Minimizes the need for secondary substructure and **reduces installation time**
- **Secondary substructure is not essential** depending on the type of substrate
- Allows installation of **very wide elements**

*The MILO® solution complies with the requirements of the CSTB (code of practice for building works) depending on the material used and type of substrate.*

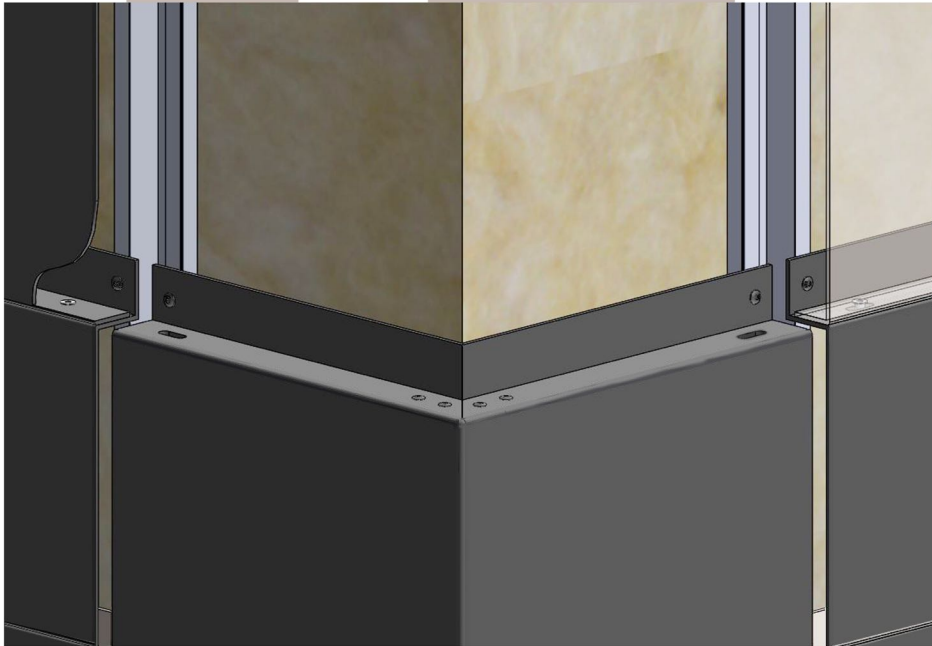

HORIZON  
range solution

- 1 Substrate
- 2 Insulation
- 3 Right angle fixing bracket
- 4 Secondary substructure
- 5 Insert on the lower fold of the slat
- 6 Metal or composite cladding

