

JAVA®

ACODI
architecture créative



HORIZON
range solution

INSTALLATION OF MODULES FITTED WITH CLIPS

- Suited to horizontal façade layout as well as for soffits
- Especially adapted to brick style joint layouts
- **Minimizes thickness of the overall system**
- Easy installation after modifying the basic profile
- Provides **very deep vertical recessed joints**, allows **projecting vertical metal profiles** or other fixing elements to pass through (solar shading, perforated screening ..)
- Offers option of selecting of the **width of the vertical joints**
- Offers option of selecting the width of the horizontal recessed joints

The JAVA® solution complies with the requirements of the CSTB (code of practice for building works) depending on the material used and the type of substrate.

www.acodi.fr

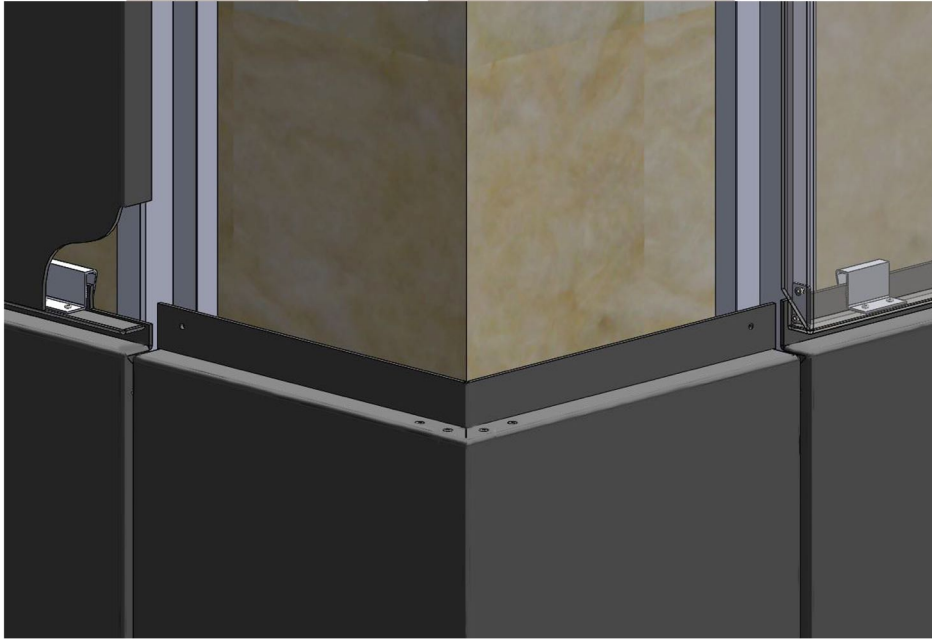

HORIZON range solution

- 1 Substrate
- 2 Insulation
- 3 Right angle fixing bracket
- 4 Secondary substructure
- 5 Clip fixed on to the tray panel
- 6 Metal or composite cladding

