



## ALLURE range solution

### OMEGA BRACKET FIXINGS

- Suited to both vertical layouts and to soffits, and particularly recommended for relatively narrow **vertical slats**
- A **secondary substructure is not essential, making the solution suitable for use with prefabricated modules**
- Suitable for site requirements where **overall thickness should be kept to a minimum**
- Substructure pre-assembled in the workshop can be adapted or modified on site
- Ease and speed of installing the tray panels
- Offers option of selecting the width of the horizontal recessed joints

*The OURAL® solution complies with the requirements of the CSTB (code of practice for building works/ technical approval) depending on the material used and type of substrate.*

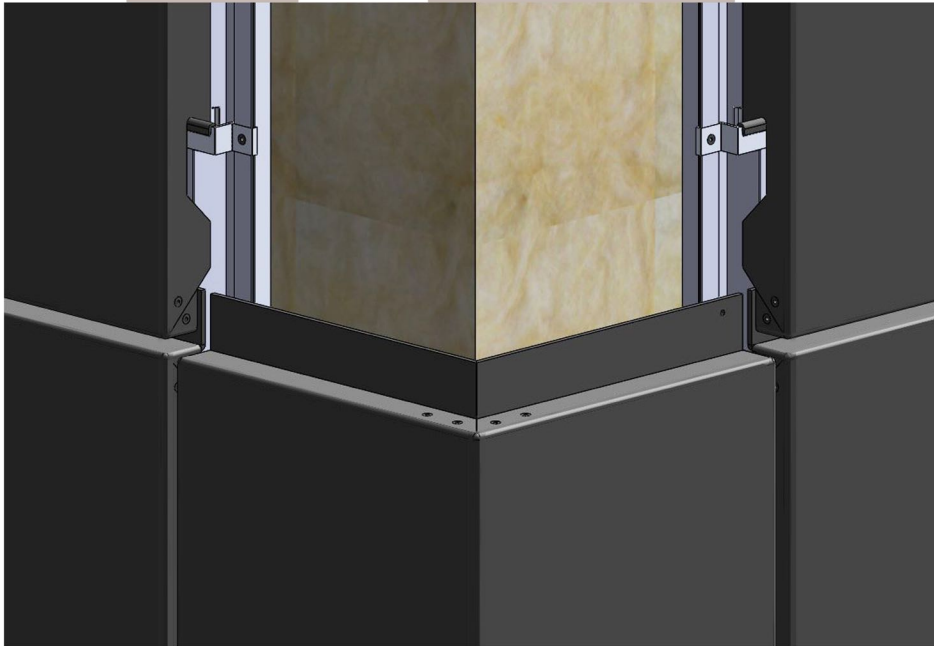

ALLURE  
range solution

- 1 Substrate
- 2 Insulation
- 3 Right angle fixing bracket
- 4 Secondary substructure
- 5 Omega bracket
- 6 Metal or composite cladding

